

Series TM holders

- ✓ T-slot mounted holder
- ✓ For use with S style standard type
- ✓ General multipurpose mounting
- ✓ For use in 400 Hydraulic series roll marking machines

Catalog No.	Max Number of Characters						Dim		
	1/16	3/32	1/8	5/16	3/16	1/4	A	B	C
TMA-20	32	21	16				2	1/4	4 1/2
TMA-30	48	32	24				3	1/4	4 1/2
TMB-30				16	16		3	5/16	6 1/4
TMC-30						12	3	3/8	6 1/4

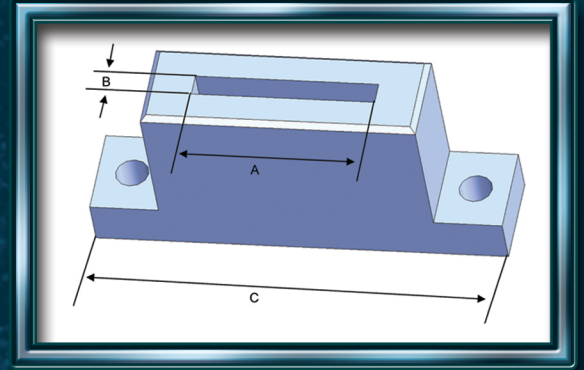

Holder & stamps

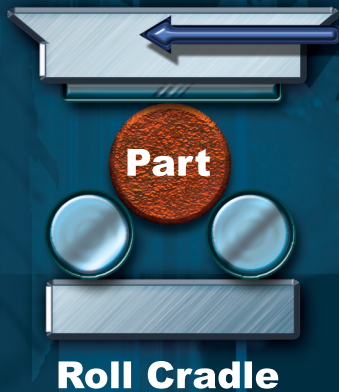

Roll Cradles mounted on the work table of a roll marking machine provide a free turning rest for marking round or conical parts.

- ✓ Standard sizes available for various diameter parts
- ✓ Custom roll cradles are useful for conical parts or parts having several diameters

Catalog No.	DIM		Dim over rollers to mounting face	For Part Diameters
	A	B		
RC-0	3/4	1 3/4	1 9/16	1/4 to 7/16
RC-1	1	2	2 1/16	3/8 to 1
RC-2	1	2	2 5/32	1 to 2 1/4
RC-3	1 1/4	2 1/4	2 3/32	2 1/4 to 4
RC-4	1 1/4	2 1/4	2 1/8	4 to 6 1/2

